



ADDENDUM 1

March 18, 2025

ITB PW 26-25

Okaloosa County New Tax Collector Office Building

Please find the attached document and information below, for the above referenced Addendum 1. This Addendum is hereby made a part of the Contract Documents and Specifications of the above referenced project. All other requirements of the original Contract Documents and Specifications shall remain effective in their respective order.

The purpose of Addendum 1 is to address vendor questions submitted prior to the last day for questions date.

I. Questions / Answers

Question #1: Is there an engineer's estimate or budget for this project?

Answer #1: The County anticipates a budgetary range of \$10-\$20M.

Question #2: How is the seating, tables, workstations and the furniture for the offices being quoted?

Answer #2: Furniture is Owner Purchase/Owner Installed

Question #3: Ref. Project Manual, Section 00 11 16 (1.1) & (1.7) A. Notice to bidders. Prequalified bidders may submit bids for project as described in this document. Can contractors still be qualified to bid for this project? If so, what documents are required to be approved?

Answer #3: There is no pre-qualification required for a bidder to submit. This standard language is applicable to roadway type work related to FDOT standards.

Question #4: Please provide hardware sets for the following openings on the project: 104D & 144. There are openings that show hardware sets that are not in the doors schedule: 103D, 136B, and 143A. Please provide clarifications on these items.

**Answer #4: Door 104D – HW Set #118
Door 144 – HW Set #131
Doors 103D, 136B & 143A are not in the project**

Question #5: SF-402 on the Window Schedule is calling for 60 Min Rated storefront, but the Door Schedule is showing that this is not a Rated door. Does this door/storefront need to be Rated?

Answer #5: Provide 60 minute fire related door for Door 402

Question #6: Opening 143B which is a FRP pair exterior opening on the drawings is using hardware set 120, which is for a single interior opening with just shows hinges with a passage lockset. What are openings 101P, 101Q and 101R? Are not shown on floor plans. Please advise.

**Answer #6: Door 143B – Provide HW Set #4
Delete Doors 101P, 101Q & 101R from Door schedule. They are not in the project.**

Question #7: Please provide deadline (time and date) to submit questions on the project.

Answer #7: March 20, 2025 @ 3:00 P.M.

Question #8: Will this project have prevailing wages/certified payroll? If so, please provide Wage Determination.

Answer #8: No-Davis-Bacon Act requirements are not in the project documents.

Question #9: Looking thru the hardware, the exit devices from Von Duprin call for hurricane wind, not impact rated. Winds of 144 per FBC call for the exits to be a HH impact rated instead of an HW. Please clarify

Answer #9: Provide HH in lieu HW for Exit devices to comply with Florida Building Code.

Question #10: Continuous hinges for the exterior aluminum show them to be pin and barrel, stainless steel. We recommend that these be aluminum geared hinges which would be FBC rated.

Answer #10: Provide per Manufacturer's Florida Approved tested assembly system. See Instructions to Bidders for substitution and required forms. See Section 01 25 00 Substitution Procedures.

Question #11: Alternate 13 & 14 state to provide wood door surround raised panel design on wood door, what panel design do we price? 1 panel, 2 panel, etc.

Answer 11: See Interior Elevations for Door Surround Panels

Question #12: The notes on E-051 request coordination of existing and new poles for this site. Do you know if the existing light poles associated with this project are under the leased lighting agreement with FPL? If so, is there any requirement on the electrical contractor's behalf to extend the existing circuits and relocate light poles.

Answer 12: Yes, coordinate requirements with FPL per notes. Contact at FPL is connie.oglesby@fpl.com

Question #13: Fire Rated Aluminum Entrances - For the Aluminum Entrances at fire rated wall, will the wall be sprinkled on both sides?

Answer 13: Yes

Question #14: Please provide additional information on the signage as well as a signage schedule.

Answer 14: See AS-XXX Series Drawings for requested information

Question #15: SC-101 Keynotes specify a IPro camera part numbers. Will replacing these with Hanwha cameras be acceptable?

Answer 15: See instructions to Bidders for substation requests and required forms. See Section 01 25 00 Substitution Procedures.

Question #16: Are Honeywell FIRE-LITE, Honeywell Silent Knight and Gamewell FCI approved equals for Addressable Fire Alarm Systems?

Answer 16: See instructions to Bidders for substation requests and required forms. See Section 01 25 00 Substitution Procedures.

Question #17: 28 46 21 approved manufacturer basis of design is Edwards EST4 Series, Please advise if Siemens is an accepted equal?

Answer 17: See instructions to Bidders for substation requests and required forms. See Section 01 25 00 Substitution Procedures.

Question #18: There is a discrepancy on the Cornice supports on sheets 1/s-311 and a1/a-502. On the structural, it is called out as bent plate 8x8x1/4, but on the architectural it is called out as 7x4x3/8 angle. Likewise, the lintels are called out differently on the structural and architectural as well, 4/s-502 and C2/a-54.

Answer 18: Provide an 8"H x 7"W x 3/8"T bent plate per structural detail. Provide lintels per structural drawings.

Question #19: Specification Section 07 41 1316 for the standing seam metal roof call out .050 thick aluminum. This thickness is not available. The Basis of Design for the roofing is Tite-Loc Plus by Pac-Clad. This material comes in .032 and .040 thickness. Please clarify

Answer 19: Provide 0.040 thickness.

Question #20: Digital Signage is mentioned on E-051. If this is included in the RFP, please provide additional information on digital signage i.e. dimensions, materials, mfr, etc. In addition, dimensional letter signage is noted in the specs but no details on the drawings. Please provide additional information i.e. dimensions, material, etc.

Answer 20: See AS-XXX drawings for requested information

Question #21: Reference Section 00 43 36 - Proposed Subcontractors Form. As a General Contractor, please consider allowing the list of subcontractors to be submitted 24 hours after the bid date due time.

Answer 21: Provide per specification section 00 22 13 Supplementary Instructions to Bidders 1.5.E.

Question #22: In the metal fabrications section, Elevator pit sump cover (2.7)(b), it calls for 8-w-grating. Can we substitute 19-w-4? The specs for the bollards (2.10) callout a bolt on style bollard, but on sheet d4/A5.05, it shows a cast in place style bollard. Which one is correct?

Answer 22: 19-W-4 is acceptable for Sump pit cover. Provide bollards per D4/A505

Question #23: Reference 00 43 73 - Proposed Schedule of Values. Please consider this requirement to only apply to the apparent low bidder.

Answer 23: Provide as per specifications once, a selection is announced.

Question #24: Drawings. On sheet A-111 it is calling for a SF103A and SF105 to have a 60-minute fire lite in an aluminum frame. This can only be done if both sides are sprinkled. Please advise.

Answer 24: See Specification 08 41 13.13 Fire-rated Aluminum Framed Entrances and Storefronts. The building is fully sprinklered.

Question #25: Drawings. On sheet C2, all the proposed asphalt appears to be the same thickness. On sheet C8, the details are showing standard and HD asphalt paving. Please identify on sheet C2 the location of the different paving thickness.

Answer 25: The proposed asphalt should be the 1.5" asphalt, detail #6.

Question #26: Section 07 41 13 16 Standing Seam Metal Roof Panels page 4 of 12 para 2.4.A.3.a is calling for .050 inch roof panels. Manufacturers can not produce this panel out of .050 aluminum. This panel can be produced out of .040 aluminum.

Answer 26: Provide 0.040 thickness.

Question #27: Section 07 41 13 16 Standing Seam Metal Roof Panels page 4 of 12 para 2.4.A.3.c is calling for the exterior paint finish to be three-coat fluoropolymer. This is a very expensive paint finish and you will not gain any more finish or material warranty than you would with the standard 2 coat kynar paint finish.

Answer 27: Provide per specifications.

Question #28: Section 07 42 93 Metal Soffit Panels page 4 of 10 para 2.2.B.2.c is calling for the exterior paint finish to be three-coat fluoropolymer. There is not enough quantity of this material to get a 3-coat kynar paint finish. This is a very expensive paint finish and you will not gain any more finish or material warranty than you would with the standard 2 coat kynar paint finish.

Answer 28: Provide per specifications.

The solicitation opening date remains April 2, 2025 at 3:00 p.m. (CST).



48 HOURS
BEFORE YOU DIG
CALL SUNSHINE ONE
1-800-432-4770
www.callsunshine.com

NOT FOR CONSTRUCTION

PROJECT NO.	24-812
DATE	12/2024
SCALE	1"=20'
FILE NO.	24-34
DATE	12/2024
PROJECT NO.	24-812
DATE	12/2024
SCALE	1"=20'
FILE NO.	24-34

OKALOOSA COUNTY
TAX COLLECTOR'S OFFICE
DRAINAGE PLAN



Seaside Engineering And Surveying, LLC
655 Highway 19 N
Baker, FL 32531
Ph: (850) 550-9512
Fax: (850) 398-8812

DATE:	03/10/25
BY:	M.C.G.
DATE:	03/10/25
BY:	M.C.G.
DATE:	03/10/25
BY:	M.C.G.

REVISIONS	DATE	BY	DESCRIPTION

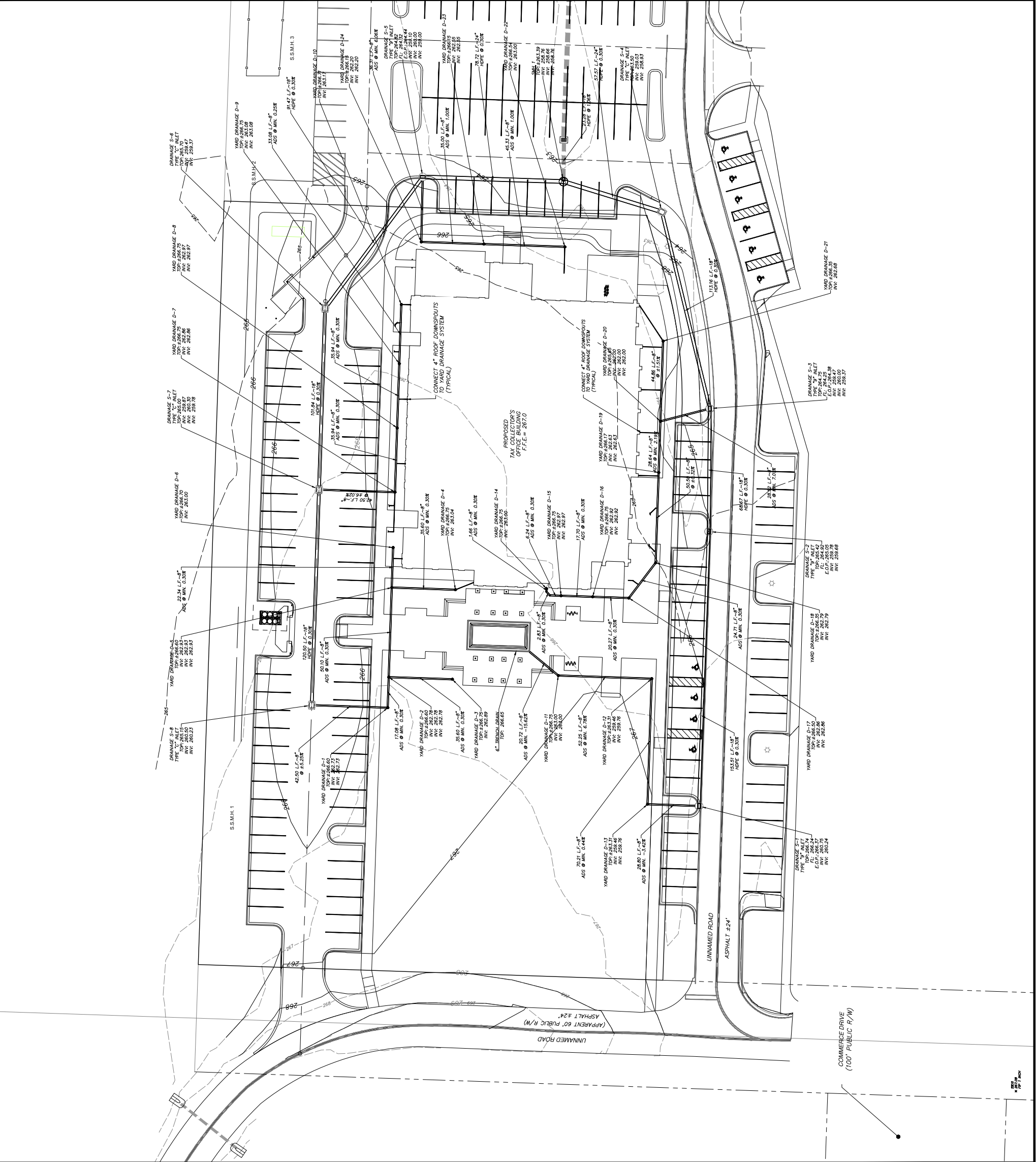

- NOTES**
1. TOPOGRAPHIC SURVEY BY SEAS ENGINEERING AND SURVEYING, LLC, PERFORMED MAY 2024. ELEVATIONS SHOWN HEREON ARE REFERENCED TO MADD88.
 2. BENCHMARKS: AS SHOWN
 3. CONTOUR INTERVAL = ONE FOOT
 4. PROPOSED CONTOURS AND SPOT ELEVATIONS REPRESENT FINISHED GRADE.
 5. SPOT ELEVATIONS ALONG CURB REPRESENT FINISHED GRADE AT BACK OF CURB UNLESS OTHERWISE LABELED.
 6. STORMWATER RUNOFF, SEDIMENT, AND EROSION SHALL BE CONTROLLED DURING ALL PHASES OF CONSTRUCTION.
 7. MATCH EXISTING EDGE OF PAVEMENT GRADE WHEREVER NEW PAVEMENT MEETS THE EXISTING EDGE.
 8. CONTRACTOR SHALL PROVIDE SOLID SODDING WITHIN THE RETENTION BASINS AND ALL OTHER CLEARED AND GRUBBED AREAS WITH SLOPES OF 3:1 OR STEEPER.
 9. PRIOR TO FINAL APPROVAL BY CITY OF CRESTVIEW PUBLIC WORKS, THE CONTRACTOR SHALL SUBMIT A DRAINAGE PLAN INCLUDING CONSTRUCTION EROSION CONTROL, STORMWATER MANAGEMENT PLAN, SPECIFICALLY EROSION, GRADING, RUNOFF CONVEYANCE AND RETENTION BASIN RECOVERY TIME. THIS WILL BE VERIFIED.
 10. ANY EXISTING VEGETATION OUTSIDE THE LIMITS OF CONSTRUCTION SHALL BE RETAINED AND WILL MEET THE REQUIREMENTS OF THE CITY OF CRESTVIEW LAND DEVELOPMENT CODE.
 11. ROOF DOWNSPOUTS SHALL BE CONNECTED TO YARD DRAINAGE SYSTEM.

LEGEND

---	EXISTING GRADE CONTOUR (AT 5' INTERVAL)
---	EXISTING GRADE CONTOUR (AT 1' INTERVAL)
---	FINISHED GRADE CONTOUR
---	SILT FENCE LOCATION
---	SECTION LOCATION WITH SECTION NUMBER

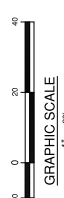

DATE: 12/2024